

# PlayStation® Input Output

Quick Start Guide

## 9510-2412

Copyright 2010-2018 Cybdyn Systems®  
<http://cybdyn-systems.com.au/>



9510-2412

Printed in China

### Quick Start Instructions

## PlayStation® Input Output

### 1. Install the Switch Board

For PSIO to function, a Switch Board must be soldered onto your PlayStation® mainboard. Failure to do so will render the cartridge unusable.

- Locate the included Switch Board Kit in this box. The kit contains the Switch Board, label and wire.
- Install the Switch Board by soldering it onto your PlayStation® mainboard.

**NOTE:** The Switch Board installation guides and information about why this is required are available at: [http://ps-io.com/switch\\_board](http://ps-io.com/switch_board)

### 2. Copy the Menu System

- Format an SD Card (4 GB to 32 GB Cards should be formatted as FAT32 and anything above 32 GB must be formatted as exFAT).
- Download the PSIO Menu System from: <http://ps-io.com/downloads>
- Copy and paste 'MENU.SYS' to the root of the SD Card.

### 3. Add Software Images

- Find an image that you would like to add to the SD Card.
- Ensure it is a PlayStation® format image (BIN, ISO or IMG extensions permitted only).
- Copy it to a folder on the SD Card.  
 EG: 'SD:\DEMO 1\demo1.bin' (where 'SD:\' is the root directory).

---

## 4. Insert the SD Card

Insert the SD Card into your PSIO Cartridge. Make sure that it is inserted in the correct direction as seen in the diagram below.

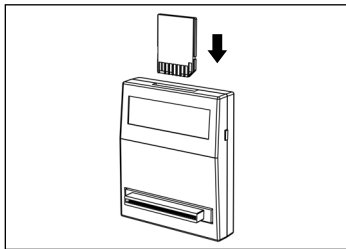

---

## 5. Plug In and Power On

Firmly plug your PSIO Cartridge into the PlayStation® Parallel I/O Port and power on your console (as seen in the diagram below).

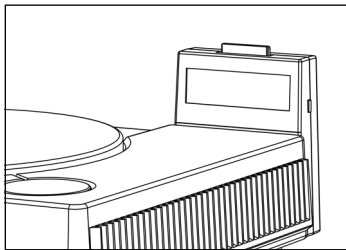

---

## 6. Setup the Menu System

When you power on your PlayStation® the Menu System will begin the setup process.

- Follow the on-screen prompts to configure the Menu System.

**NOTE:** If you ever need to reset the Menu System, hold [START] + [SELECT] whilst the PlayStation® is booting.

---

## 7. Select a Software Image

- Use the [DIRECTIONAL BUTTONS] to scroll through the list of software images and press the [CROSS] button to make a selection.
- Press the [CROSS] button again to boot the selected software image.
- To select a new software image, press the [RESET] button on the PlayStation® console.

---

## Basic Troubleshooting

It is strongly recommended that your PSIO cartridge is up-to-date with the latest firmware(s). For information on how to update, please refer to the 'Systems Manual' here: <http://ps-io.com/downloads>

If you have any other issues with your cartridge or if further issues persist, please report them here: <http://ps-io.com/problem>

---

## Frequently Asked Questions

**Q: When I select my image why do I get a message saying "No Image Found"?**

A: Make sure that the software image filename does not exceed 60 characters and is either a BIN, ISO or IMG file.

---

**Q: When I plug in my PSIO Cartridge why does it not boot to the Menu System?**

A: Ensure that you have installed the Switch Board correctly and the 'MENU.SYS' file has been copied to the root of the SD Card. Also check that the PlayStation® Parallel I/O Port is not corroded or damaged and that the cartridge is plugged in firmly.

---

**Q: My software images are not playing any audio. Why can't I hear any music or background audio?**

A: Most software images use Compact Disc Digital Audio (CDDA). To learn how to enable CDDA, please refer to the 'Systems Manual' here: <http://ps-io.com/downloads>